

Field View - Access Statement

Introduction

This access statement does not contain personal opinions as to our suitability for those with access needs, but aims to accurately describe the facilities and services that we offer all our guests/visitors.

Our property is a traditional Cotswold stone cottage situated in Tetbury market town, Gloucestershire. Tetbury is situated in the south east part of the Cotswolds, approximately 24 miles north of Bath and 28 miles north-east of Bristol. The Cottage is situated at the top end of Cottons Lane, about 2 mins walk from the long stay car park in West Street and 10 mins walk from the town centre of Tetbury. The property has 3 bedrooms, split between the first floor and roof room on the second floor.

If you require this information in a different format, please contact Tanya Adams email:

If you have any further queries or require any assistance please phone 07811176898 or email: htcadams@yahoo.co.uk

Pre-Arrival

- There is extensive information about Field View on our website:
- You can find our location and directions see map link.
- Bookings / enquiries can be made by via email or telephone 07811 176898 or 020 8133 4872 .
- The nearest bus stop is approximately half a mile away in the High Street. There are approximately 7 bus routes from the town. No. 27 Old Sodbury, No. 29 to Stroud, No. 129 Leighterton and Stroud, No. Tetbury Circular, 374 Did-Martin to Stroud, No. 881 to Cirencester and Kemble.
- The nearest train station is at Kemble 7 miles away. Train connections to London Paddington, Swindon, Stroud and Gloucester.
- There are accessible taxis available locally.

Key Collection, Welcome and Car Parking Facilities

- The key for the door is in a coded key safe - details of location and code will be sent to you by us prior to your holiday.
- Parking is approximately 2minute walk in the West Street Long Stay car park. On street parking can be found on West Street and The Cut.
- Luggage can be dropped off, by driving down Cottons Lane, and stopping by the archway (see map). Cottons Lane is lightly trafficked and allows time for drop off, load and un-loading. However, it is a narrow lane and parking spaces are very limited and generally already in use by local residents in the near by cottages.

Field View

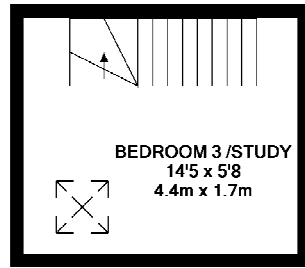

2ND FLOOR
APPROX. FLOOR
AREA 167 SQ.FT.
(15.5 SQ.M.)

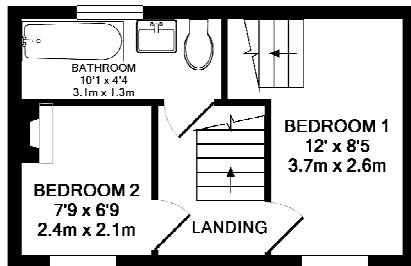

1ST FLOOR
APPROX. FLOOR
AREA 229 SQ.FT.
(21.3 SQ.M.)

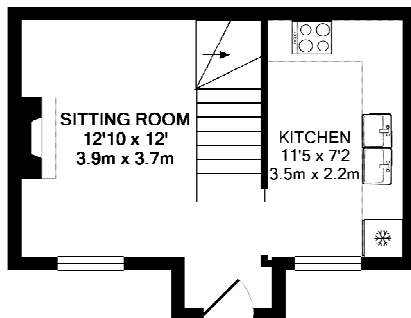

GROUND FLOOR
APPROX. FLOOR
AREA 241 SQ.FT.
(22.4 SQ.M.)
TOTAL APPROX. FLOOR AREA 637 SQ.FT. (59.2 SQ.M.)

While every effort has been made to ensure the accuracy of these floor plans, the measurements should not be used as the basis for any purchase or sale of property. The plan is for illustrative purposes only and should be used as such by any prospective purchaser. Made with Hologram 1.0.17.

The Plan is not to scale. Sourced from Estate Agents at time of acquisition.

The stair ways are lit, and have balustrades. They do not have hand rails.

Entrance To The Property

- The entrance to the property is through an archway, along pathway to the front gate. The archway and pathway are around 1m 30cm wide. There is a small step at the front gate - 10 cms high, The gate is 90 cm wide. The front door has a small step over the door lintel of 12 cm. The doorway is 75 cm wide.
- There are movement detector lights which switch on at night. The road outside is lit with street lights.
- The porch light beside in the entrance doorway is switched on from the inside of the cottage porch.

Halls, Stairs, Landings, Passageways

- The front door is 75 cm wide and the key hole lock is 105cm high.
- Inside the entrance there is an entrance hall porch with pegs and space for coat, shoes and umbrella.
- The hall opens into lounge with the kitchen being accessed via the lounge.
- It is a wooden floor with a rug in the lounge. The stairs and bedrooms have fitted carpet.
- The bathroom has a natural stone tile floor.

Sitting Room / Lounge

- There is a doorway into the lounge 90 cms wide.
- Flooring is polished wooden floor with rug.
- Furniture is moveable.
- One fabric double sofa and 1 fabric tub chair, padded window seat
- Table with four chairs, which can be extended.
- Wall mounted television, on moveable arm, with internal DVD. Wifi box.
- Small music and radio system.
- Red log burner.
- Bookshelf with range of books and DVD's, storage cupboard.
- 3 free standing lamps.
- Stairs to first floor lead directly out of the lounge.

Kitchen

- Doorway from lounge into kitchen is 85 cm
- The worktop height is 94 cm
- Electric fan oven with drop down door with electric hob above
- Double butler Sink at worktop height with small cupboards underneath
- Lighting is spotlight bulbs on ceiling, with under unit lighting.
- 44 cms free space between cupboards and worktops.

- Good contrast between floor, cupboards and other surfaces.
- Fridge with freezer compartment.
- Front loading washing machine.
- Microwave on work surface.
- Flooring polished wooden floor.
- Flooring is dark with light coloured cupboards.
- Smoke heat alarm fitted.

Stairway

- Carpeted stairway, with turn. 80cm wide, with 90degree turn after third step.
- 13 stairs in total. Average, 18 cm high, 20 cm deep.

Bedrooms and Sleeping Areas

Master Bedroom

- Door width 75 cm.
- Double bed (4 ft 8")
- Bed height 45 cm floor to top of mattress.
- Non feather duvets and pillows anti-allergenic provided.
- Wardrobe full length hanging, width 70 cm.
- Bedside drawers 58 cm high.
- Largest free space clear of doors and furniture is 190 cm by 95 cm.

Second Loft Bedroom

- Accessed by stairway from main bedroom. Width 70 cm, 90 degree turn at third step.
- Average stair, 23 cm high and 24 cm deep.
- Low beam on access to room.
- Room set in pitch of roof, max height 193 cm
- Velux window 105 wide, 110 high. Fitted blind.
- One single 3 ft 4" bed provided
- Bed height 38 cm floor to top of mattress.
- Non feather duvets and pillows anti-allergenic provided.
- Bedside table/chest of drawers is 74 cm high.
- Small wardrobe hanging space, 80 cm wide, 140 cm high.

Third Bedroom

- Doorway 67 cm wide.
- Single Futon for sitting or sleeping. 90 cm wide and 190 long when stretched out.
- Bedside table 46 cm high
- Limited walking space when futon stretched out.

- Wall clothes hanging unit, 190 cm high, with hangers.

Bathrooms, Shower-rooms and Toilets

Bathroom

- Door width 69 cm.
- Bath with mixer shower.
- Wall mounted valve, shower provided. Non slip mat provided for bath.
- Bath height is 56 cm, length 148 cm.
- Toilet seat height 43 cm.
- Space in front of toilet 60 cm to left.
- Flooring is tiled with a bath mat.
- Wash basin height 83 cm.
- Fan ventilation, can be switched off separately to lights.
- Shaver plug provided

Grounds and Gardens

- Grassed area to side of the property level with the car parking area.
- The enclosed exterior decking can be accessed via the lounge, or via the decking along the side of the lodge.

Additional Information

- Heating is provided by gas central heating throughout. There is a log burner in the lounge for additional heat and ambience.
- Information folder in lodge is produced in size 12 font.
- Good mobile phone reception is poor inside the stone cottage, however a signal usually can be obtained from the porch or garden.
- Wireless internet access available.
- The property is no smoking throughout, although smoking is permitted in the terraced garden and an ashtray is provided.
- No pets are allowed.

Future Plans

- We will review our property through feedback from our guests and make any changes accordingly
- We welcome your feedback to help us continuously improve if you have any comments please email us on htcadams@yahoo.co.uk.

Our Contact Information

- Address: Field View, 4 Cottons Lane, Tetbury, Gloucestershire, GL8 8DP
- Please contact: Tanya and Paul Adams
- Telephone: +44 (0)20 8133 4872 or 07811 176898

- Email: htcadams@yahoo.co.uk
- Web site:
- Grid Reference: ST888929.